

Park Smart Homework 2 (P1-P3)

"Note to Parents"

Why Park Smart?

If you can walk, scoot or cycle to school instead of driving, even for part of the way, you can:

- Have some quality time with your children on the journey to and from school
- Make your school journey less stressful and chaotic
- Probably save some money on fuel

Homework instructions:

The map over the page shows cars parked in different locations. Remember what we talked about in class about good and bad places for cars to park near school, then on the map:

- Colour in **RED** all the cars that are parked badly, in dangerous places
- Colour in **GREEN** all the cars that are parked well, in safe places.

If you can, explain to an adult why you think some should be red and some should be green.

Remember that cars should never park or wait:

- On school zig-zag markings
- On yellow lines
- On footways
- In locations where pupils need to cross roads
- Across drop kerbs
- On street corners
- Blocking people's driveways
- On grass verges
- At bus stops

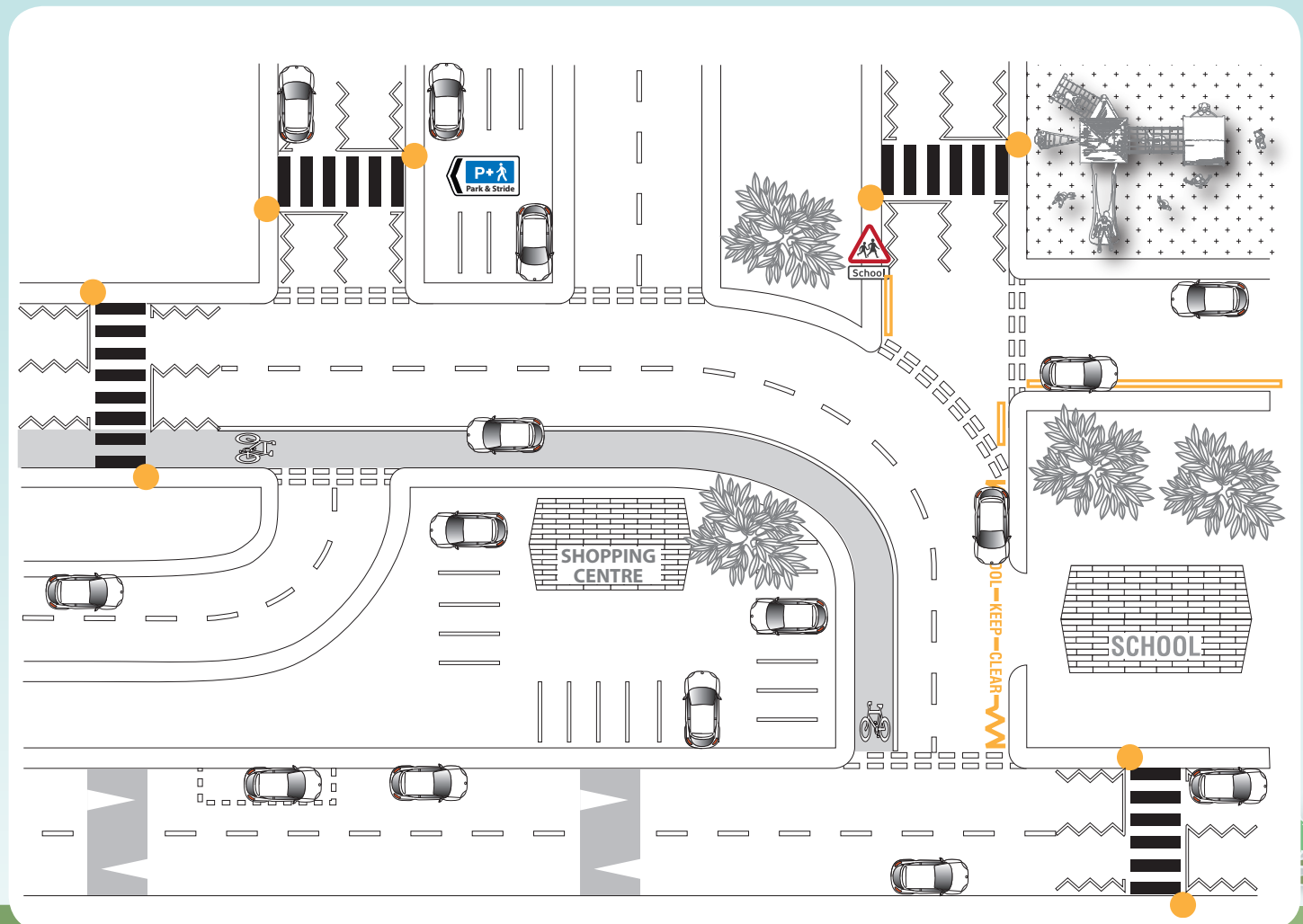

— SCHOOL — KEEP — CLEAR —

If you do need to drive, then parking smart will mean that you don't put your own children or other people at risk around the school.